

PICTOR® GPS TRACKER

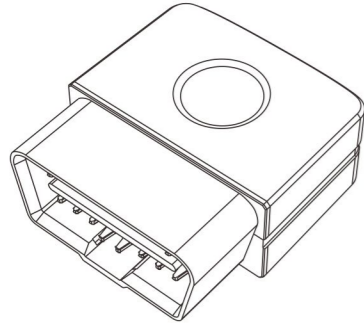

Please read the installation instruction manual carefully before installation and use.

1 Appearance

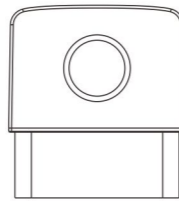

2 Product Features



ACC detection



Geo-safe



Low battery



SMS



Trace Playback



Tracking



Disassemble alarm



Over-speed alarm

*The OBD device is suitable for most vehicle models

3 Inside The Box

Check your product for the following items

- Device X 1
- User manual X 1

4 Product Parameters

Name	Parameter
Power Supply	Vehicle Battery
Working Voltage	DC 9V - 35V
Built-in Battery	80 mAh (3.7V Polymer Battery)
Working Temperature	-20°C - 70°C
Locate Mode	GPS/BDS/LBS
Size	47mm * 43mm * 20mm
Location Accuracy	≥5m (The data is only for references, The positioning error is related to geography, time, etc.)

5 Structure Description

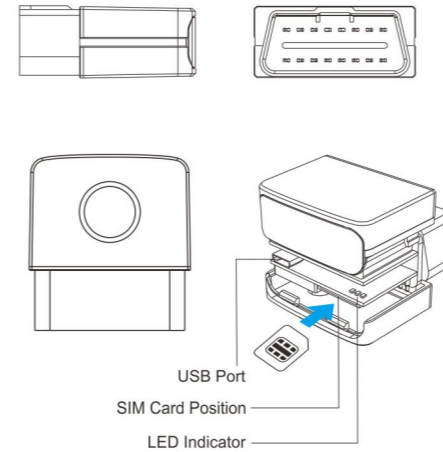

6 Interface Definition Table

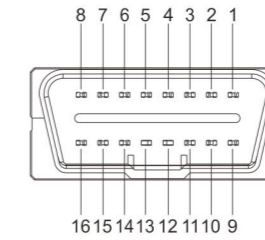

Definition	Pin	Definition	Pin
1	N/A	9	N/A
2	N/A	10	N/A
3	N/A	11	N/A
4	GND	12	N/A
5	GND	13	N/A
6	CAN_H	14	CAN_L
7	K_BUS	15	L_BUS
8	N/A	16	B+

7 LED Indicator

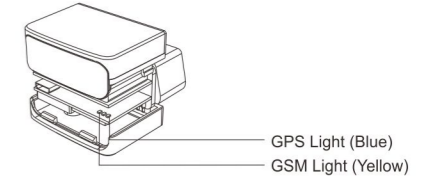

Yellow (GSM Light)	Description
Fast Blinking	GSM Initialization
Slow Blinking	GSM Works Normally
No Lights	GSM In Sleep Mode

Blue (GPS Light)	Description
Fast Blinking	Searching For GPS Signal
Slow Blinking	GPS Works Normally
No Lights	GPS In Sleep Mode

8 Functions

1. Disassemble Alarm

When the terminal power is cut off, the disassembly alarm of device will be triggered. The platform will receive a disassembly alarm.

2. Geo-fence

After setting up the fence area and selecting the alarm conditions on the platform, the alarm will be triggered according to the alarm conditions in order to remind the service platform, when the terminal enters or leaves the fence area.

3. Over Speed Alarm

The maximum speed allowed can be set by SMS or platform. When the speed exceeds the set maximum, the overspeed alarm will be triggered and the platform will receive the overspeed alarm information.

4. Timeout Alarm

The maximum allowable vehicle stay time can be set by SMS and platform. Once the vehicle stay time exceeds the set maximum value, the timeout alarm will be triggered and the platform will receive the timeout alarm.

5. ACC Detection

When the device detects the ACC on or off of the vehicle, the platform will receive a corresponding alarm.

9 Product Installation

Installation Diagram

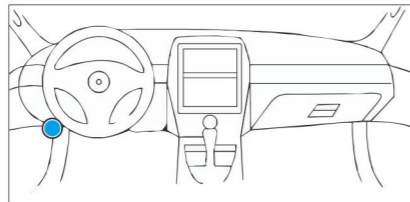

Install the device to the OBD II interface directly. After the indicator light of the device works normally, check whether the device is on line on the platform.

10 Precautions

Please make sure the OBD II tracking device is installed properly, which is not easy to be shaken.

11 Quick Operation Instructions

1. APN setting

To ensure GPRS is active, please make sure APN is correct. You can send SMS command to set APN.
APN command
Format: **APN123456 APN's Name**
Eg.: **APN123456 internet**
(*'internet' is the APN of carrier)

2. Server Setting

Default platform is www.wanwaygps.com
To connect other platform, please send the SMS command to change the server IP:

Domain setting
Format: **IP Domain Port**

Eg.:
IP WW9808.gpsog.com 9808

3. Check Param Setting

You can check the parameter setting by command: CXZT
Eg.: CXZT

Reply Content includes:
ID, IP, APN, ACC, GPRS, GPS, etc.

12 Operation of Device

Check Location

Via platform
Check the position of the vehicle from platform website or APP(WanWayTrack).

13 Trouble Shooting

Problem	Description	Solution
Failed to connect the internet	SIM card not installed	Check the SIM card
	SIM card not installed properly	Install again
	No GSM network	Move the device in GSM network area
	Weak GSM network	Move the device in strong GSM network area
Location failed	SIM card has no GPRS functions	Contact Sim card supplier to activate the GPRS function
	Always reply "failed to get location"	Contact the supplier
No GPS location	Some poor signal areas like basement, tunnels are not able to receive GPS signals.	Move the device to open sky areas.

14 Access to Platform

1. Platform (www.wanwaygps.com)
2. Android and iOS APP(Scan the QR code to download APP)



WanWayTrack

There are two methods to log in to the platform or APP.

1. Login by IMEI number(the 15 digits in the back of the device), password: the last 6 digits of imei number.
2. Contact the supplier to create an account for you.